

ELEVATION - FEMALE END

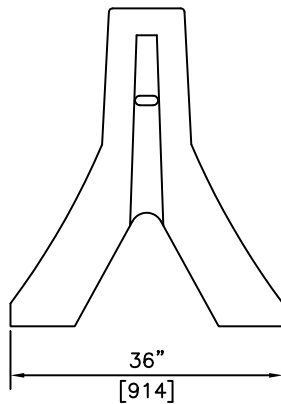

ELEVATION - FEMALE END

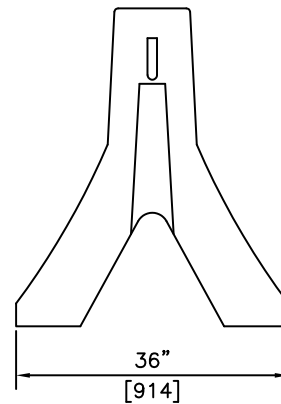

ELEVATION - MALE END

NOTES:

1) 27.6MPa @ 28 DAYS

REVISED: MAR 16 2005

 <p>KON KAST products (2005) Ltd. "Committed To Quality And Service"</p>	<p>3440 UNIVERSITY WAY KELOWNA B.C. V1V 1V9 PH: (250)765-1423 FX: (250)765-0820</p>	BY: PKR	<p>SEAWALL RETAINING WALL</p>	ITEM NO.
		DATE: MAR 16 05		<p>1502</p>
		SCALE: NTS		

RECOMMENDED INSTALLATION

1. LEVELLING PAD TO BE FORMED USING 3/4" (19) CRUSH COMPACTED TO 100% STANDARD PROCTOR DENSITY. PAD TO BE 20" (510) WIDE. DEPTH TO BE DETERMINED BY PROJECT ENGINEER.
2. BACKFILL MATERIAL TO BE COMPACTED TO 95% STANDARD PROCTOR DENSITY. ALL BACKFILL SHALL BE FREE DRAINING, NON-FROST SUSCEPTIBLE GRANULAR MATERIAL WITH NO MORE THAN 5% PASSING THE #200 SIEVE.
3. ANY VARIATION FROM RECOMMENDED INSTALLATION REQUIRES REVIEW BY A PROFESSIONAL ENGINEER. SOIL CONDITIONS REQUIRE REVIEW BY A GEOTECHNICAL ENGINEER PRIOR TO CONSTRUCTION.
4. LEVELLING PAD TO BE CONSTRUCTED IF NOT ON UNDISTURBED GROUND, WITH A MINIMUM BEARING CAPACITY OF 3000 P.S.F.
5. PRECAST BLOCKS ARE 8" WIDE x 6" HIGH x 10" DEEP (203x152x254). WEIGHT = 39 POUNDS EACH.
6. GEOGRID MUST BE USED WHEN WALL HEIGHT EXCEEDS 18" (450). WALLS MAY THEN BE DESIGNED TO 10ft (3M) PLUS IN HEIGHT.

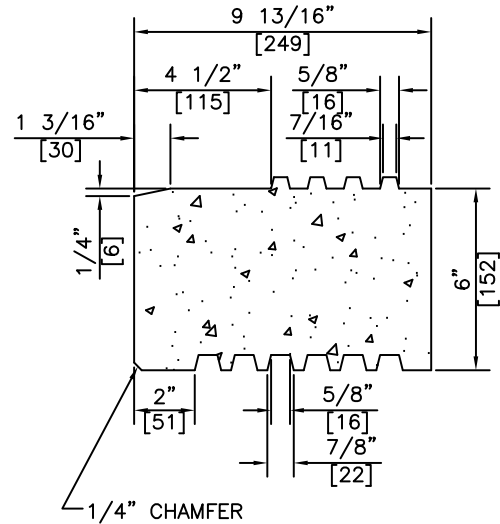

TYPICAL BLOCK SECTION

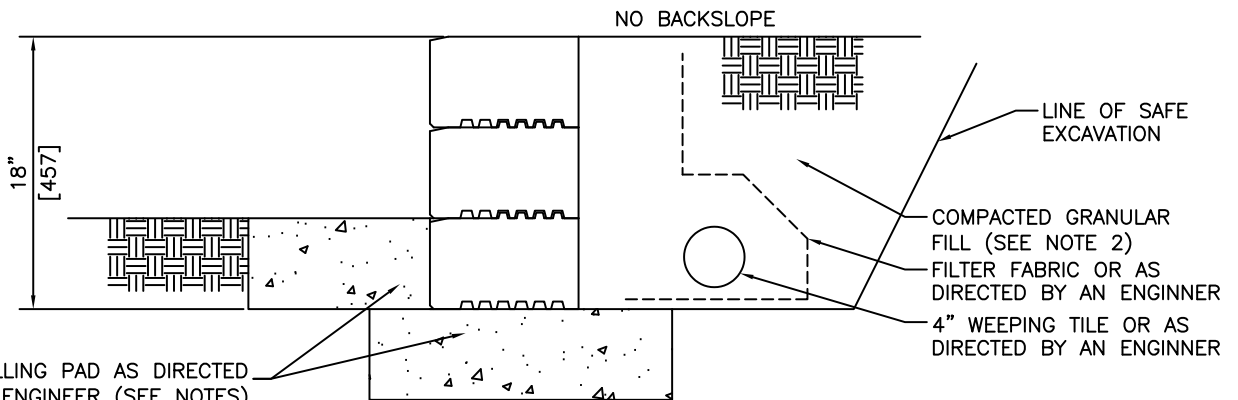

LEVELLING PAD AS DIRECTED BY AN ENGINEER (SEE NOTES)

NOTES:

TYPICAL SECTION

REVISED: MAR 17 2005



KON KAST
products (2005) Ltd.
"Committed To Quality And Service"

3440 UNIVERSITY WAY
KELOWNA B.C.
V1V 1V9
PH: (250)765-1423
FX: (250)765-0820

BY: PKR

DATE: MAR 17 05

SCALE: NTS

**1' 6" GEORFORCE
RETAINING WALL
SYSTEM**

ITEM NO.

1540

RECOMMENDED INSTALLATION

1. LEVELLING PAD TO BE FORMED USING 3/4" (19) CRUSH COMPACTED TO 100% STANDARD PROCTOR DENSITY. PAD TO BE 20" (510) WIDE. DEPTH TO BE DETERMINED BY PROJECT ENGINEER.
2. BACKFILL MATERIAL TO BE COMPACTED TO 95% STANDARD PROCTOR DENSITY. ALL BACKFILL SHALL BE FREE DRAINING, NON-FROST SUSCEPTIBLE GRANULAR MATERIAL WITH NO MORE THAN 5% PASSING THE #200 SIEVE.
3. ANY VARIATION FROM RECOMMENDED INSTALLATION REQUIRES REVIEW BY A PROFESSIONAL ENGINEER. SOIL CONDITIONS REQUIRE REVIEW BY A GEOTECHNICAL ENGINEER PRIOR TO CONSTRUCTION.
4. LEVELLING PAD TO BE CONSTRUCTED IF NOT ON UNDISTURBED GROUND, WITH A MINIMUM BEARING CAPACITY OF 3000 P.S.F.
5. PRECAST BLOCKS ARE 8" WIDE x 6" HIGH x 10" DEEP (203x152x254). WEIGHT = 39 POUNDS EACH.
6. GEOGRID MAY BE USED TO INCREASE WALL DESIGN HEIGHTS TO 10ft (3M) PLUS.

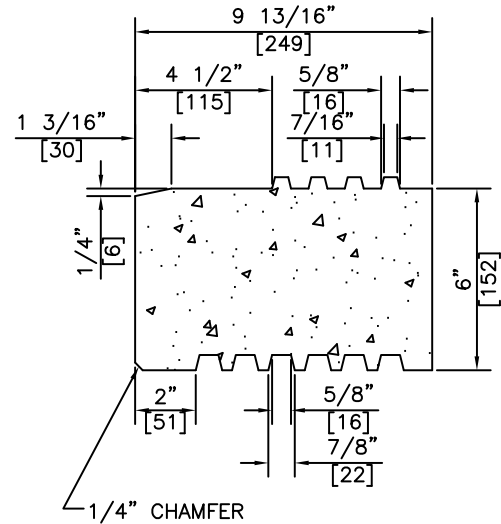

TYPICAL BLOCK SECTION

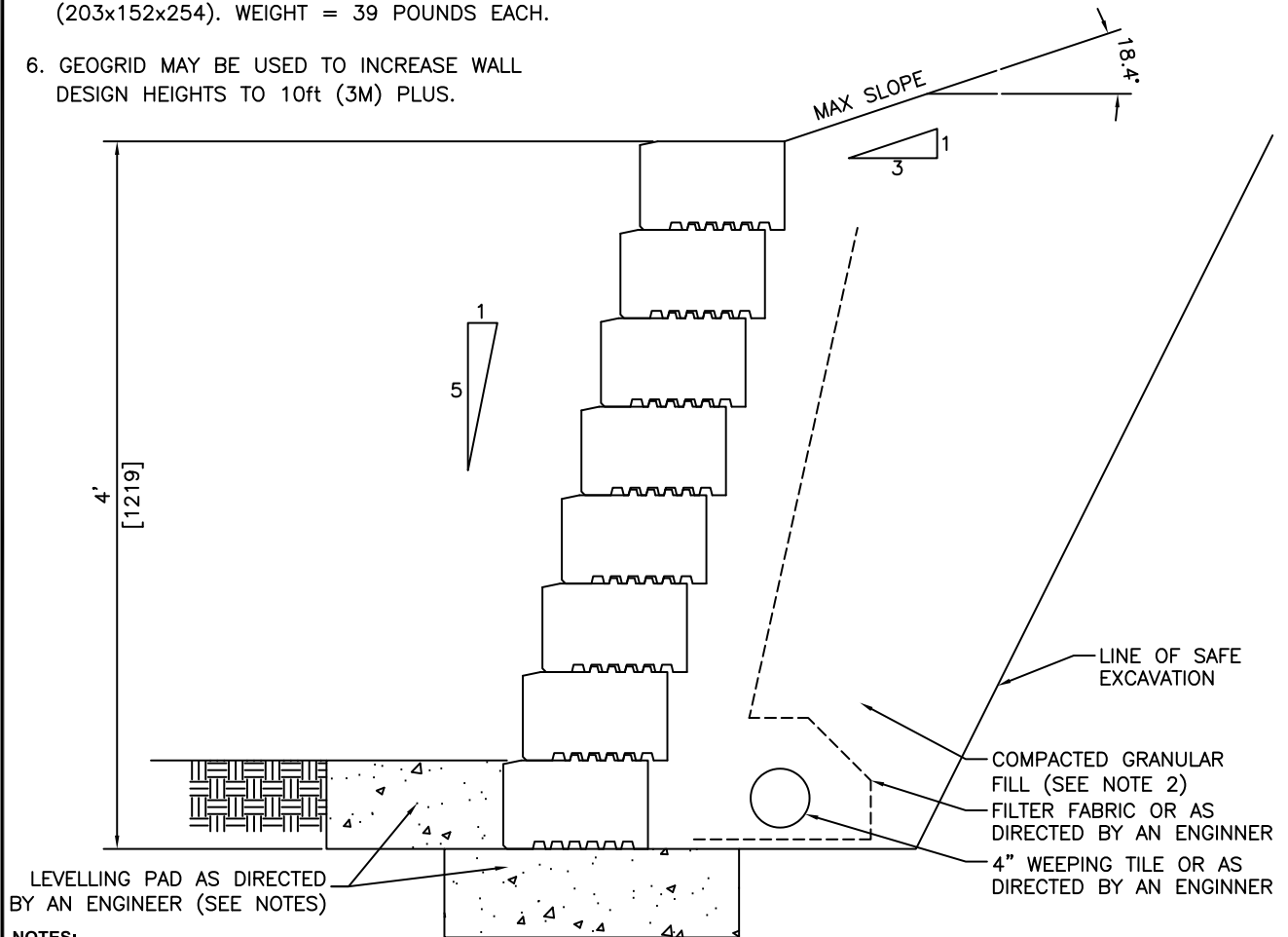

TYPICAL SECTION

REVISED: MAR 17 2005



KON KAST

products (2005) Ltd.
"Committed To Quality And Service"

3440 UNIVERSITY WAY
KELOWNA B.C.
V1V 1V9
PH: (250)765-1423
FX: (250)765-0820

BY: PKR

DATE: MAR 17 05

SCALE: NTS

**4'-0" GEORFORCE
RETAINING WALL
SYSTEM**

ITEM NO.

1540A

RECOMMENDED INSTALLATION

1. LEVELLING PAD TO BE FORMED USING 3/4" (19) CRUSH COMPACTED TO 100% STANDARD PROCTOR DENSITY. PAD TO BE 20" (510) WIDE. DEPTH TO BE DETERMINED BY PROJECT ENGINEER.
2. BACKFILL MATERIAL TO BE COMPACTED TO 95% STANDARD PROCTOR DENSITY. ALL BACKFILL SHALL BE FREE DRAINING, NON-FROST SUSCEPTIBLE GRANULAR MATERIAL WITH NO MORE THAN 5% PASSING THE #200 SIEVE.
3. ANY VARIATION FROM RECOMMENDED INSTALLATION REQUIRES REVIEW BY A PROFESSIONAL ENGINEER. SOIL CONDITIONS REQUIRE REVIEW BY A GEOTECHNICAL ENGINEER PRIOR TO CONSTRUCTION.
4. LEVELLING PAD TO BE CONSTRUCTED IF NOT ON UNDISTURBED GROUND, WITH A MINIMUM BEARING CAPACITY OF 3000 P.S.F.
5. PRECAST BLOCKS ARE 8" WIDE x 6" HIGH x 10" DEEP (203x152x254). WEIGHT = 39 POUNDS EACH.
6. GEOGRID MAY BE USED TO INCREASE WALL DESIGN HEIGHTS TO 10ft (3M) PLUS.

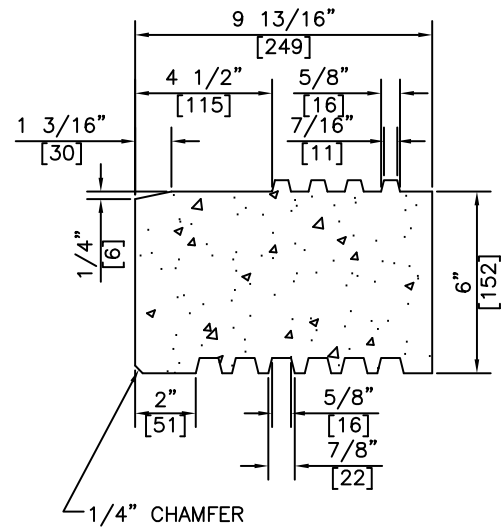

TYPICAL BLOCK SECTION

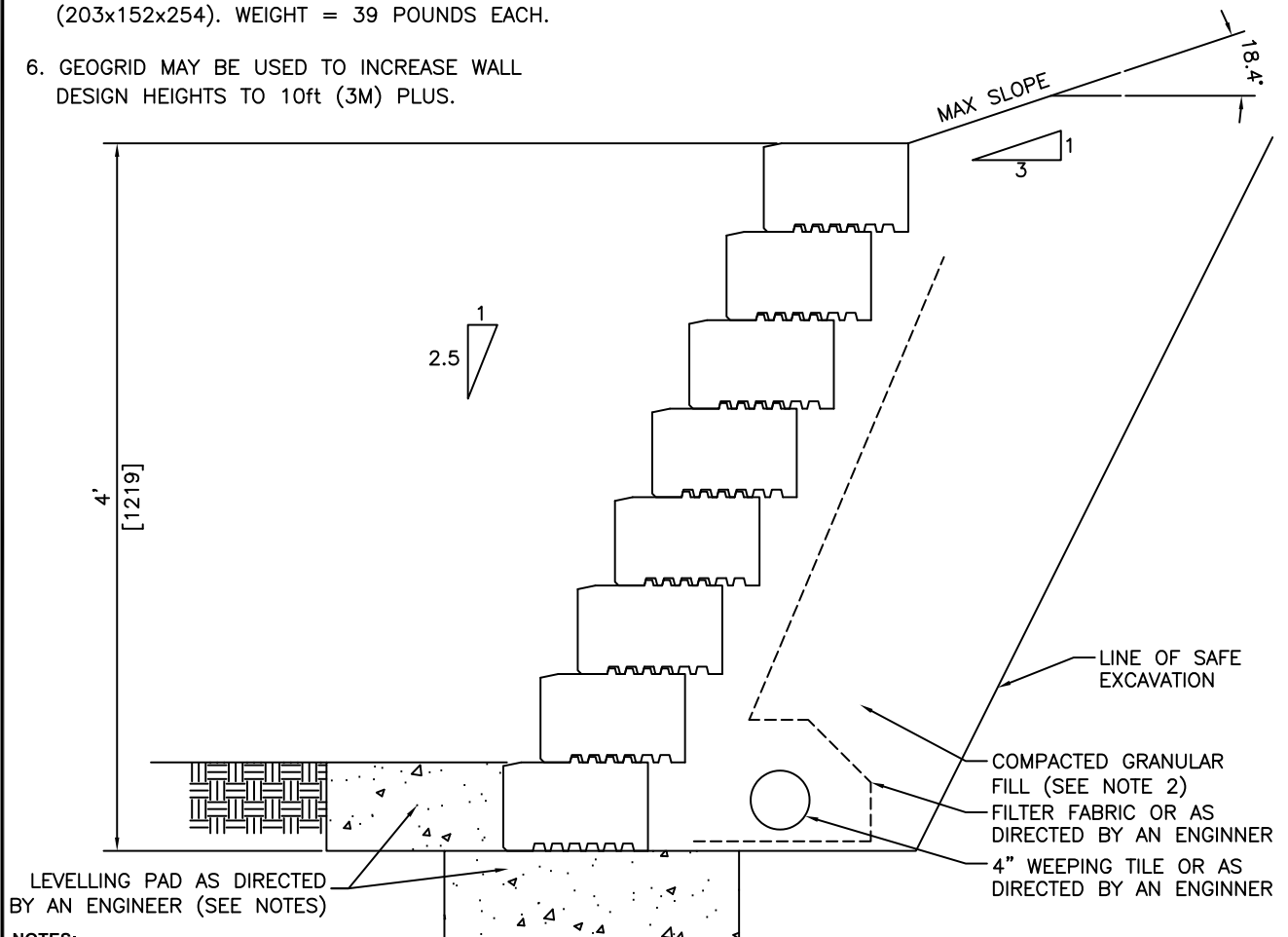

TYPICAL SECTION

REVISED: MAR 17 2005



KON KAST

products (2005) Ltd.
"Committed To Quality And Service"

3440 UNIVERSITY WAY
KELOWNA B.C.
V1V 1V9
PH: (250)765-1423
FX: (250)765-0820

BY: PKR

DATE: MAR 17 05

SCALE: NTS

**4'-0" GEORFORCE
RETAINING WALL
SYSTEM**

ITEM NO.

1540B

RECOMMENDED INSTALLATION

1. LEVELLING PAD TO BE FORMED USING 3/4" (19) CRUSH COMPACTED TO 100% STANDARD PROCTOR DENSITY. PAD TO BE 20" (510) WIDE. DEPTH TO BE DETERMINED BY PROJECT ENGINEER.
2. BACKFILL MATERIAL TO BE COMPACTED TO 95% STANDARD PROCTOR DENSITY. ALL BACKFILL SHALL BE FREE DRAINING, NON-FROST SUSCEPTIBLE GRANULAR MATERIAL WITH NO MORE THAN 5% PASSING THE #200 SIEVE.
3. ANY VARIATION FROM RECOMMENDED INSTALLATION REQUIRES REVIEW BY A PROFESSIONAL ENGINEER. SOIL CONDITIONS REQUIRE REVIEW BY A GEOTECHNICAL ENGINEER PRIOR TO CONSTRUCTION.
4. LEVELLING PAD TO BE CONSTRUCTED IF NOT ON UNDISTURBED GROUND WITH A MINIMUM BEARING CAPACITY OF 3000 P.S.F.
5. PRECAST BLOCKS ARE 24" WIDE x 12" HIGH x 72" LONG. WEIGHT = 1700 POUNDS EACH.
6. GEOGRID MAY BE USED TO INCREASE WALL DESIGN HEIGHTS TO 20ft (6M) PLUS.

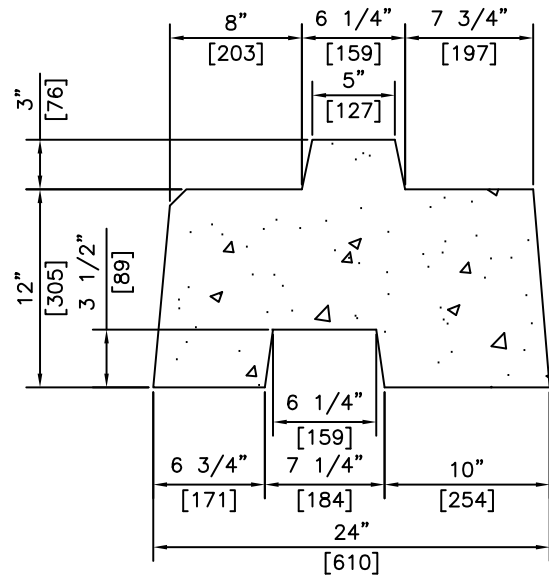

TYPICAL BLOCK SECTION

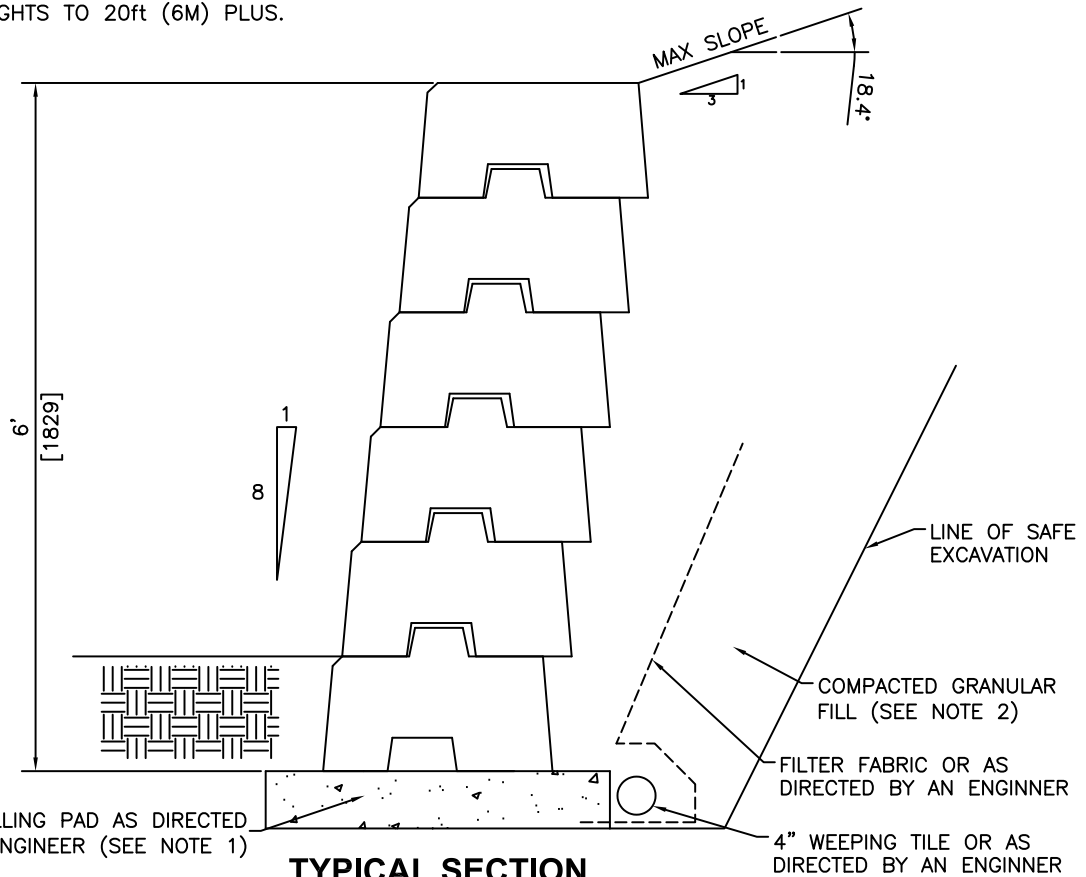

NOTES:

LEVELLING PAD AS DIRECTED BY AN ENGINEER (SEE NOTE 1)

TYPICAL SECTION

REVISED: MAR 17 2005



KON KAST

products (2005) Ltd.
"Committed To Quality And Service"

3440 UNIVERSITY WAY
KELOWNA B.C.
V1V 1V9
PH: (250)765-1423
FX: (250)765-0820

BY: PKR

DATE: MAR 17 05

SCALE: NTS

**DURA-HOLD
RETAINING WALL
SYSTEM**

ITEM NO.

1560

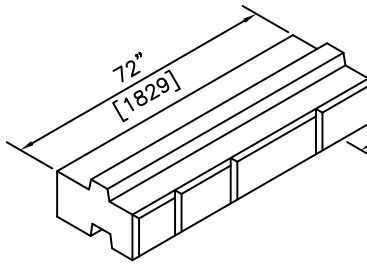

6' STRETCHER

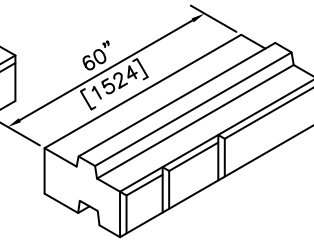

5' STRETCHER

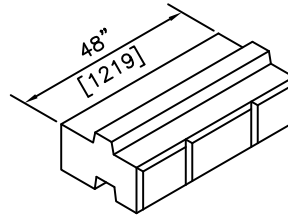

4' STRETCHER

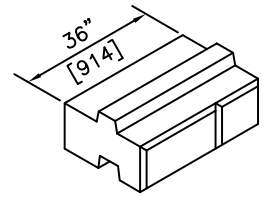

3' STRETCHER

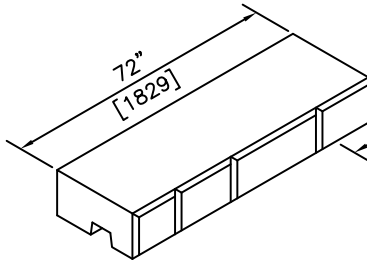

COPING

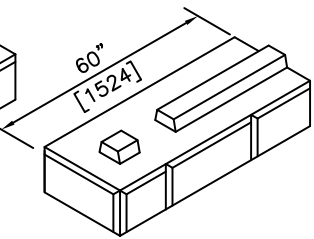

90° LH CORNER

AVAILABLE IN
RIGHT HAND

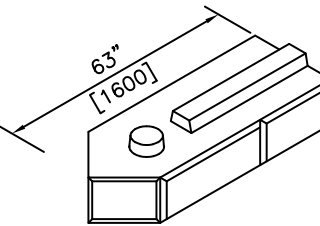

45° RH CORNER

AVAILABLE IN
RIGHT HAND

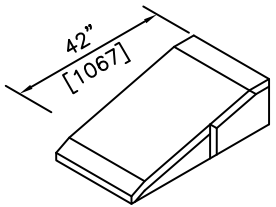

AVAILABLE IN
RIGHT HAND

TAPER

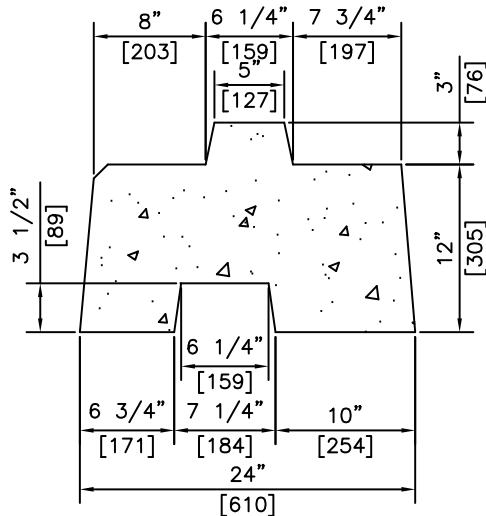

TYPICAL BLOCK SECTION

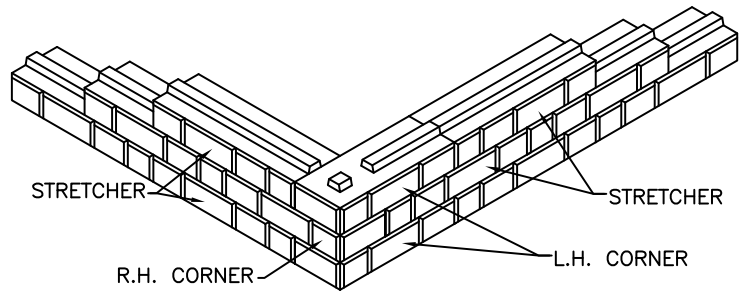

90° CORNER INSTALLATION

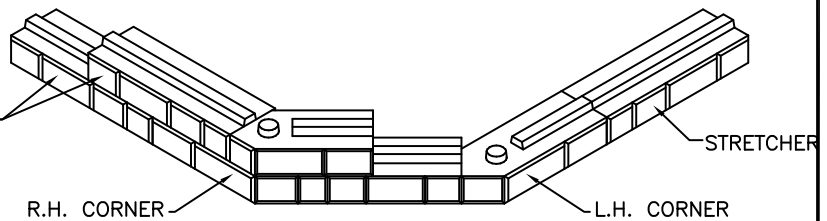

90° CORNER INSTALLATION

NOTES:

1) 27.6MPa @ 28 DAYS

REVISED: MAR 17 2005



KON KAST

products (2005) Ltd.
"Committed To Quality And Service"

3440 UNIVERSITY WAY
KELOWNA B.C.
V1V 1V9
PH: (250)765-1423
FX: (250)765-0820

BY: PKR

DATE: MAR 17 05

SCALE: NTS

**DURA-HOLD
INTERLOCKING
RETAINING WALL**

ITEM NO.

1561

